

N: 20

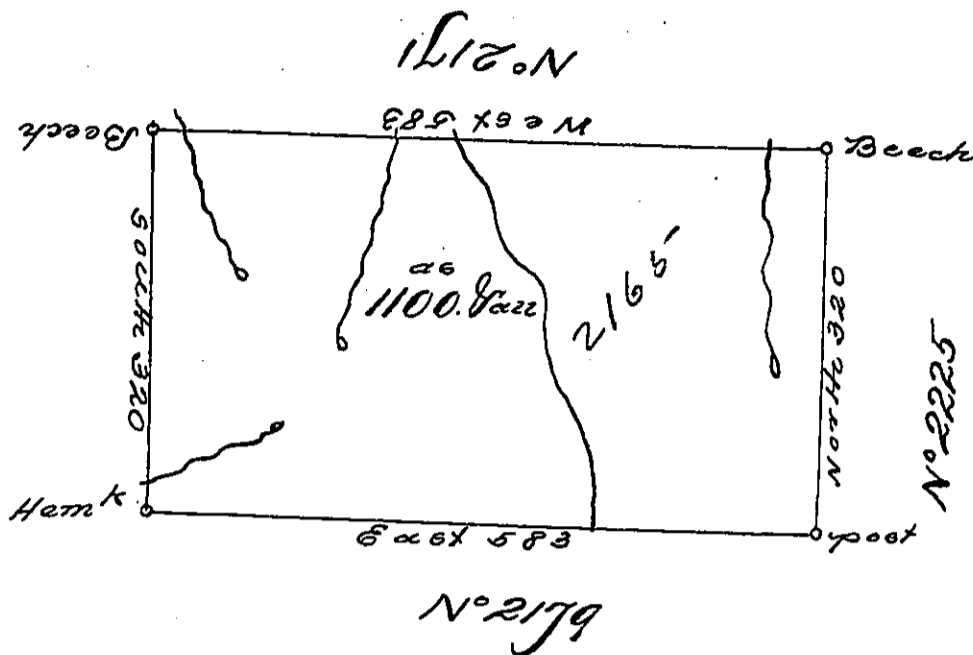

Situate half a Mile South of the Allegheny River and one Mile East of the Portage Branch of Allegheny, in North County containing 1100 acres and the usual allowance for Roads &c. Surveyed June 5th 1793. for Robert Gilmore in pursuance of a Warrant No 2165 bearing date the 12th December 1792

Daniel Brodhead Esqr.  
S.S.

John Janan D.S.

IN TESTIMONY that the above is a copy of the original remaining on file in the Department of Internal Affairs of Pennsylvania, made conformably to an Act of Assembly approved the 16th day of February, 1833, I have hereunto set my Hand and caused the Seal of said Department to be affixed at Harrisburg, this fourth day of October 1898

James W. Fitter  
Secretary of Internal Affairs.